

REV.	DESCRIPTION	DRAWN	CHECKED	APPROVED
A	NEW RELEASE	LJH 06/22/05'		

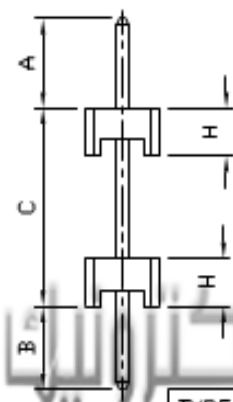
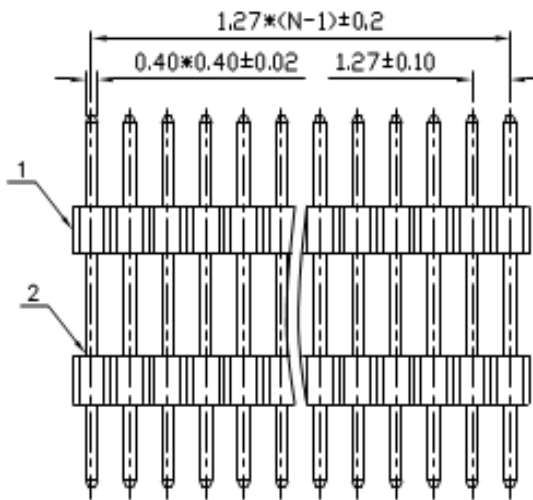
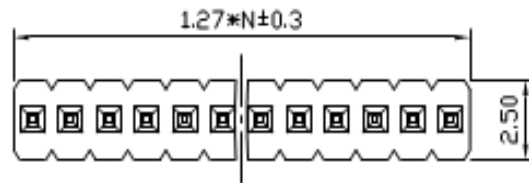

TYPE	DIM A	DIM B	DIM C
1	2.80	2.60	6.20

NOTES:

- MATERIAL
 - INSULATOR:PA-46(UL 94V-0).
 - CONTACT MATERIAL:COPPER ALLOY.
- SPECIFICATION
 - CURRENT RATING:1.0 Amp.
 - INSULATION RESISTANCE:1000MΩ Min.
 - DIELECTRIC WITHSTANDING:300VAC.
 - CONTACT RESISTANCE:50mΩ Max.
 - OPERATING TEMPERATURE:-40°C TO+105°C.
- PART NUMBER: YE1031-04
- PRODUCT NUMBER CODE:

YE1031-04 - X X X X X X X

DIM.A B C TYPE
1: TYPE 1

HOUSING HEIGHT(DIM. H)
1: 1.00mm
2: 1.50mm
3: 2.00mm

MOUNTING TYPE
V: VERTICAL TYPE

HOUSING COLOR
B:BLACK

CONTACT PLATING
8: FULL GOLD FLASH

CONNECTOR TYPE
P:PLUG

No.OF CONTACTS
1*1-1*40

SERIES No.
YE1031-04

N:No.OF CONTACTS

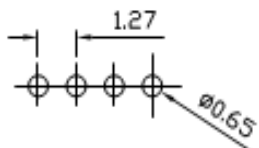

RECOMMEND PCB LAYOUT(TOLERANCE=±0.05)

GENERAL TOLERANCE		ANGLE TOLERANCE	
X.	±0.60	X.	±5'
.X	±0.38	.X	±3'
.XX	±0.25	.XX	±2'

PROJECTION		TITLE	BOARD SPACER SINGLE ROW
UNITS	mm		
SHEET SIZE	A4	SERIES	YE1031-04 SERIES

2	CONTACT		COPPER ALLOY		GOLD PLATED	DRAWING TYPE	CUSTOMER		
1	HOUSING		THERMOPLASTIC		UL 94 V-0	SCALE	1:1	SHEET	1 OF 1
ITEM	PART NAME	PART NO.	MATERIALS		FINISHED	DRAWING NO.	C-YE1031-04-XXXXXXX		

شركة يكتا الكترونك
يكتا الكترونك