

△ △ SPECIFICATION

Current Rating: 2 Amp
 Withstanding Voltage: 1000V(One Minute)
 Insulation Resistance: 1000 Megaohms Min. At DC 500V
 Operation Temperature: -50°C~+105°C
 Contact: Brass
 Gold Plated On Contact Area,
 Tin Plated On Solder Tail, Under Nickel
 Insulator: PBT+30%G.F.(UL94V-0), Blue
 Shell: SPCC, Nickel Plated Front, Tin Plated Rear
 RoHS Compliant

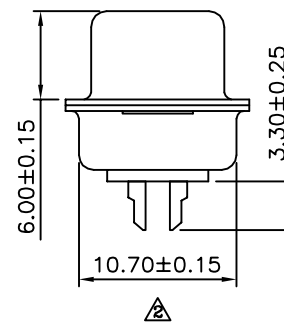

△ Pin	A	B	C	D
09	16.92	24.99	30.81	19.20
15	25.25	33.32	39.14	27.70
25	38.96	47.04	53.04	41.10
37	55.42	63.50	69.40	57.30

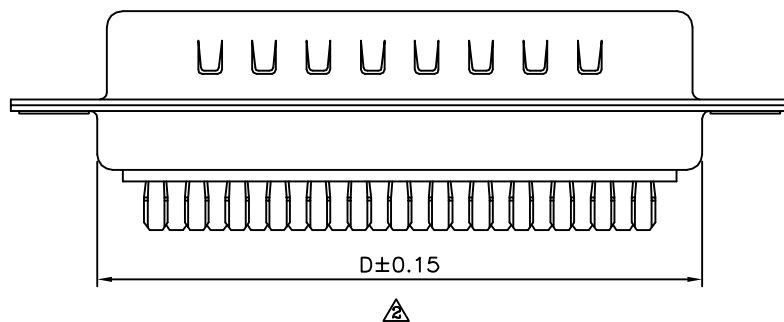
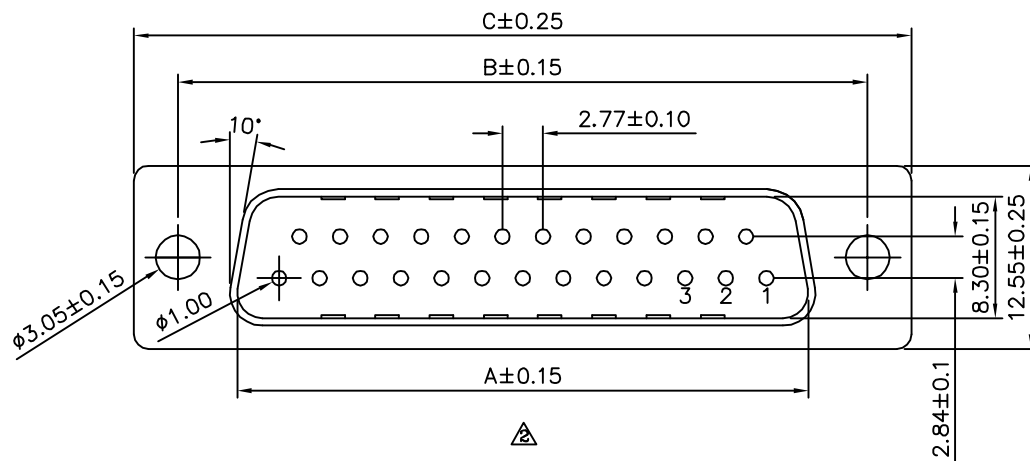

DRAWING No.

03257

APPROVED BY

MEI

CHECKED BY

HZF

DRAWING BY

WZL

SCALE

NONE

REV.

A2

UNLESS OTHERWISE SPECIFIED TOLERANCES ARE

.X ±0.25 △.X* ±3*
 .XX ±0.15 .XX* ±1*
 .XXX ±0.05 .XXX* ±0.5*

UNIT

mm



NO. REV.

REVISIONS

CHK

DATE

△ A2	Modify Data	HZF	10/05/2010
△ A1	Modify Data	HZF	12/31/2009
△ A0	NEW RELEASE	BECKY	02/06/2006