

Recommended P.C.B. Layout

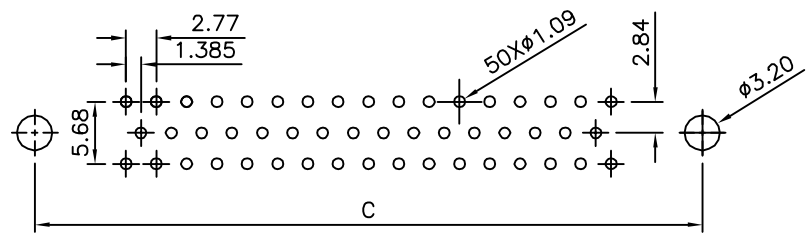

Recommended P.C.B. Layout

**SPECIFICATION**  
 Current Rating:5 Amps  
 Withstanding Voltage:1000V(One Minute)  
 Insulation Resistance:1000 Megaohms Min.  
 At 500V DC  
 Contact Resistance:20 Milliohms Max.  
 Operation Temperature:-50°C~+105°C  
 Insulator:PBT+30%G.F.(UL94V-0),Black  
 Contact:Brass,Gold Flash Over Nickel  
 Shell:SPCC,Front:Nickel Plated,Rear:Tin Plated  
 RoHS Compliant

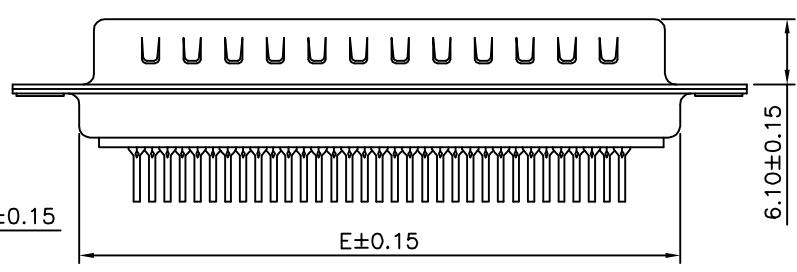
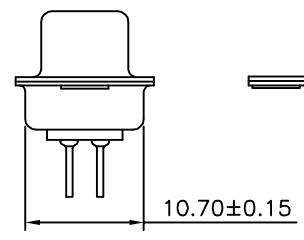
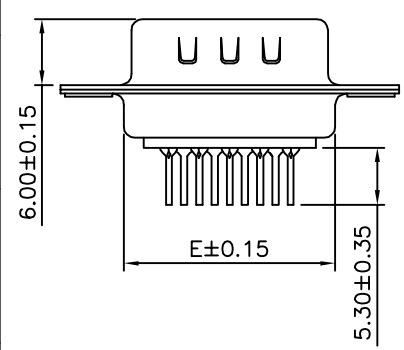
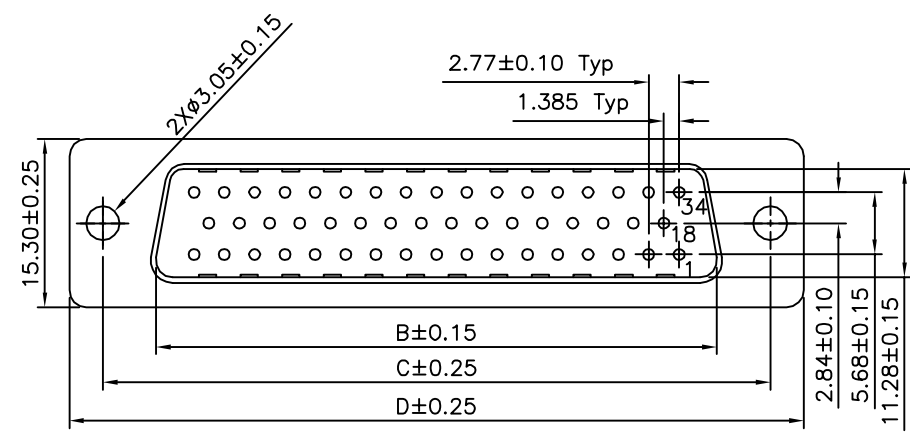
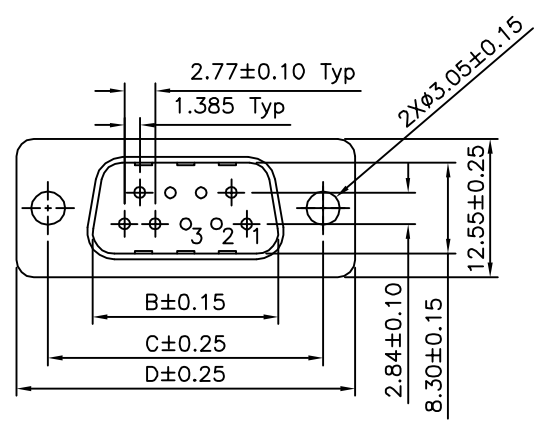

50 Pin

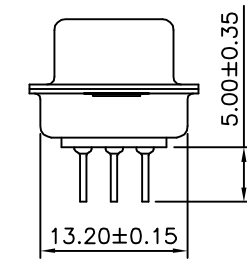

09,15,25,37 Pin

| Pin | B     | C     | D     | E     |
|-----|-------|-------|-------|-------|
| 09  | 16.92 | 24.99 | 30.81 | 19.20 |
| 15  | 25.25 | 33.32 | 39.20 | 27.70 |
| 25  | 38.96 | 47.04 | 53.04 | 41.10 |
| 37  | 55.42 | 63.50 | 69.40 | 57.30 |
| 50  | 52.81 | 61.00 | 67.00 | 55.10 |



|             |      |             |    |   |
|-------------|------|-------------|----|---|
| DRAWING No. |      | APPROVED BY |    | UNLESS OTHERWISE SPECIFIED TOLERANCES ARE<br>.X ±0.38 .X' ±3"<br>.XX ±0.25 .XX' ±1"<br>.XXX ±0.05 .XXX' ±0.5" |
| 02876       |      | MEI         |    |   |
|             |      | HZF         |    |   |
|             |      | DRAWING BY  |    | UNIT mm   |
|             |      | WSS         |    |   |
| SCALE       | NONE | REV.        | A0 | NO. REV.  |

|          |             |     |            |
|----------|-------------|-----|------------|
| AO       | NEW RELEASE | HZF | 07/06/2011 |
| NO. REV. | REVISIONS   | CHK | DATE       |