

No. of Contact	A ± 0.25 ± 0.10	B ± 0.13 ± 0.005	C ± 0.38 ± 0.015	D
09	16.92 .666	24.99 .984	30.81 1.213	11.08 .436
15	25.25 .994	33.32 1.312	39.14 1.541	19.39 .763
25	38.96 1.534	47.04 1.852	53.04 2.088	33.24 1.310
37	55.42 2.182	63.50 2.500	69.32 2.729	49.86 1.963

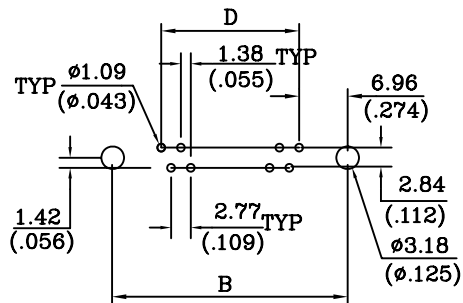
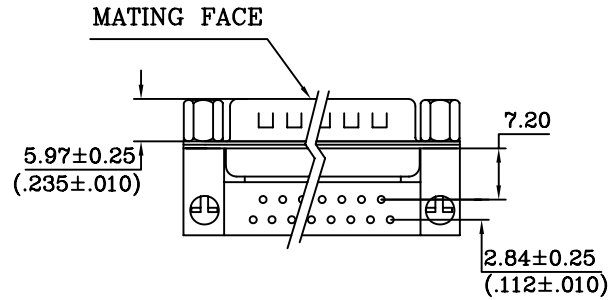
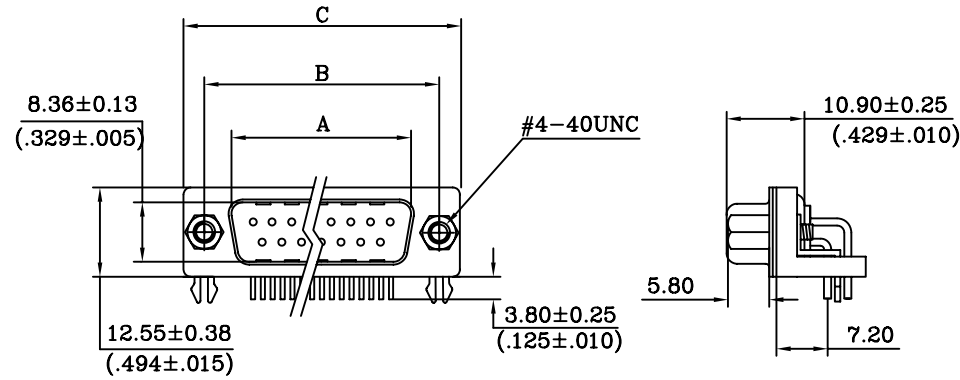

P.C.B LAYOUT

MATERIALS AND FINISH

SHELL : STEEL MATERIAL, FRONT SHELL NICKEL FINISHED
BACK SHELL NICKEL FINISHED

INSULATOR : PBT THERMOPLASTIC, 30% GLASS
FILLED, UL 94V-0 RATED, WHITE COLOR

CONTACT MATERIAL : BRASS
CONTACT FINISH : FULL 3u" GOLD

ELECTRICAL CHARACTERISTICS

CONTACT CURRENT RATING : 5.0 AMPS
CONTACT RESISTANCE : 30 MILLIOHMS MAX.
DIELECTRIC WITHSTANDING VOLTAGE : 1000 V AC MIN.
INSULATION RESISTANCE : 5000 MEGAOHMS MIN.
TEMPERATURE RATING : -55°C ~ +105°C