

Recommended P.C.B. Layout(Top View)  
 (PCB Board Tolerance $\pm 0.05$ )

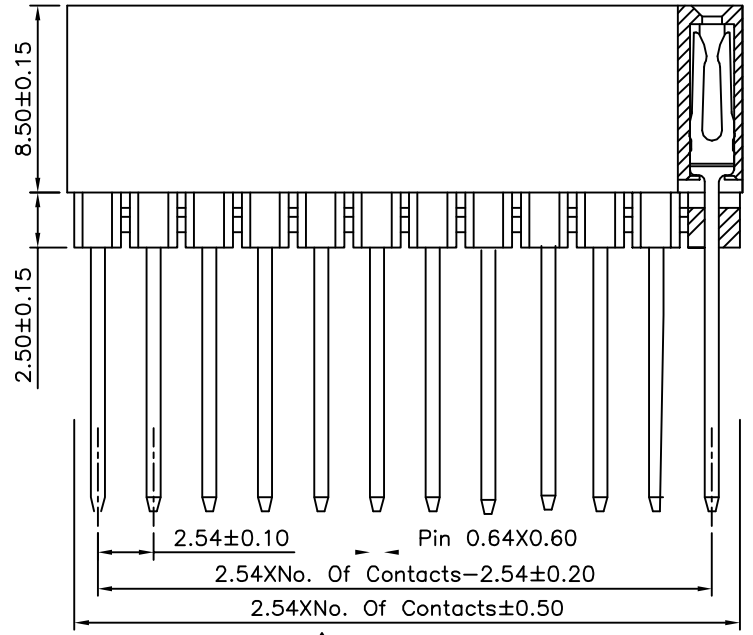

Section A-A

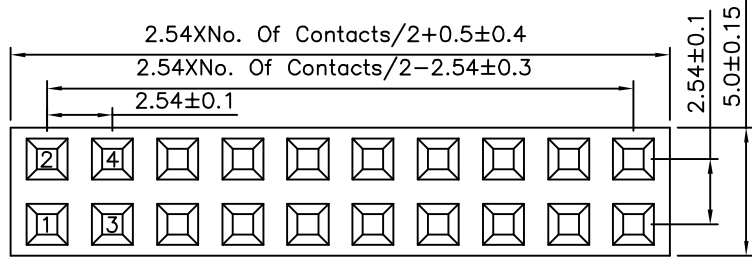
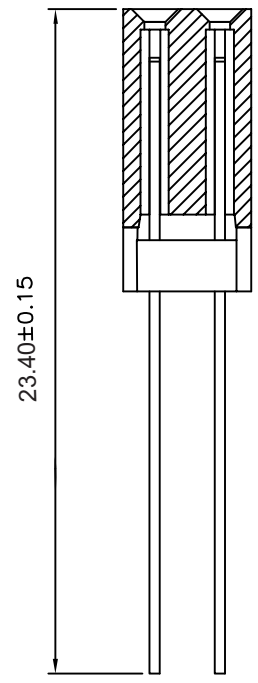

**SPECIFICATION**

Current Rating:3A  
 Withstand Voltage:1000V AC  
 Contact Resistance:20 Milliohms Max.  
 Insulation Resistance:1000 Megohms Min.  
 Operating Temperature:-40°C~+105°C  
 Insulator:PA6T(UL94V-0),Black  
 Contact:Brass,Gold Flash Over Nickel  
 RoHS Compliant

Series No.	Plastic Q'ty	H	A
0197	2	13.50	9.80
0198	3	16.00	2.00
0199	4	18.50	4.80



DRAWING No.		APPROVED BY		UNLESS OTHERWISE SPECIFIED TOLERANCES ARE X. $\pm 0.25$ X. $\pm 2^\circ$ .X $\pm 0.20$ .X $\pm 1.5^\circ$ .XX $\pm 0.15$ .XX $\pm 1^\circ$ .XXX $\pm 0.10$ .XXX $\pm 0.5^\circ$
20661		EMILY		
		HZF		
		DRAWING BY		
		HAO		
SCALE	NONE	REV.	A0	UNIT
				mm

NO.	REV.	REVISIONS	CHK	DATE
AO		NEW RELEASE	HZF	05/03/2014